

LAKE SURVEY MAP

SPECTACLE LAKE
VILAS COUNTY
SEC. 28, 29 T. 41 N. R. 12 E.

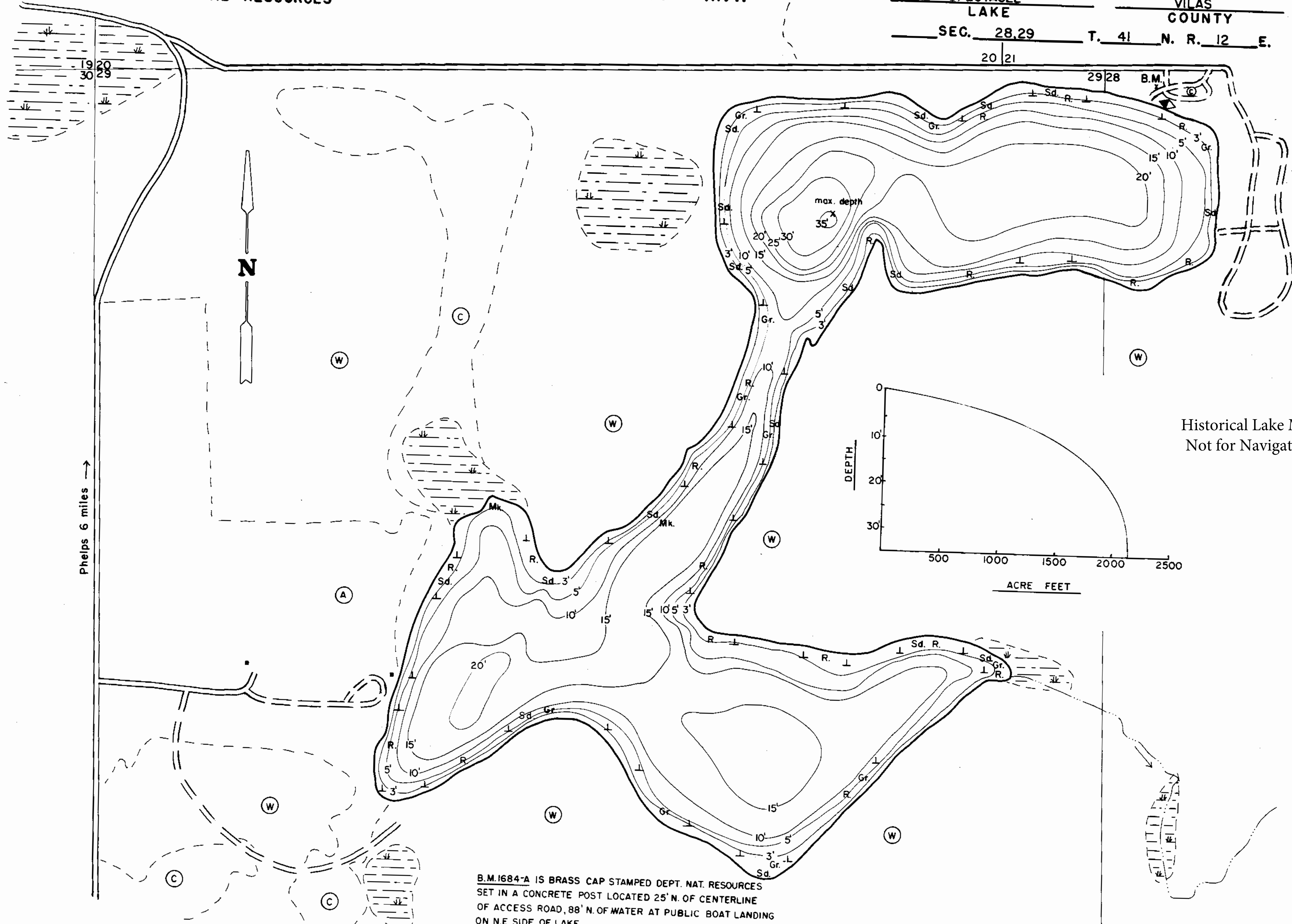

B.M. 1684-A IS BRASS CAP STAMPED DEPT. NAT. RESOURCES
SET IN A CONCRETE POST LOCATED 25' N. OF CENTERLINE
OF ACCESS ROAD, 88' N. OF WATER AT PUBLIC BOAT LANDING
ON N.E. SIDE OF LAKE.
ASSUMED ELEV. 100.00'
WATER LEVEL 93.51'
Reading taken 10/10/72

EQUIPMENT RECORDING SONAR MAPPED MAY 1970
MONTH YEAR
LAKE BOTTOM SYMBOLS

- | | | | |
|-----------------------|-------------------------------|---------------------|---------------------------|
| TOPOGRAPHIC SYMBOLS | | LAKE BOTTOM SYMBOLS | |
| (B) Brush | () Steep slope | P. Peat | B Boulders |
| (PW) Partially wooded | (---) Indefinite shoreline | Mk. Muck | Stumps & Snags |
| (W) Wooded | (---) Marsh | C. Clay | Rock danger to navigation |
| (C) Cleared | (---) Spring | M. Marl | Submergent vegetation |
| (P) Pastured | (---) Intermittent stream | Sd. Sand | Emergent vegetation |
| (A) Agricultural | (---) Permanent inlet | St. Silt | Floating vegetation |
| B.M. Bench Mark | (---) Permanent outlet | Gr. Gravel | Brush shelters |
| (■) Dwelling | (---) Dam | R. Rubble | |
| (■) Resort | (---) D.N.R. State owned land | Br. Bedrock | |
| (■) Camp | | | |

400' 0 400' 800' 1200' 1600'

SCALE

◆ Access ◆ Access with Parking ◆ Boat Livery

Drawn by: T. Ginder
Field work by: J. Smith & R. Crocker

SPECIES OF FISH			
	Abundant	Common	Present
Muskie			
N. Pike			
Walleye			
L. M. Bass		X	
S. M. Bass			
Panfish	X		
Trout			

29 28
32 33

WATER AREA 171.16 ACRES
UNDER 3 FT. 12 %
OVER 20 FT. 13 %
MAX. DEPTH 35 FEET.
TOTAL ALK. 5 P.P.M.
VOLUME 2065.19 ACRE FT.
SHORELINE 3.85 MILES