

SEC. 5  
SEC. 8

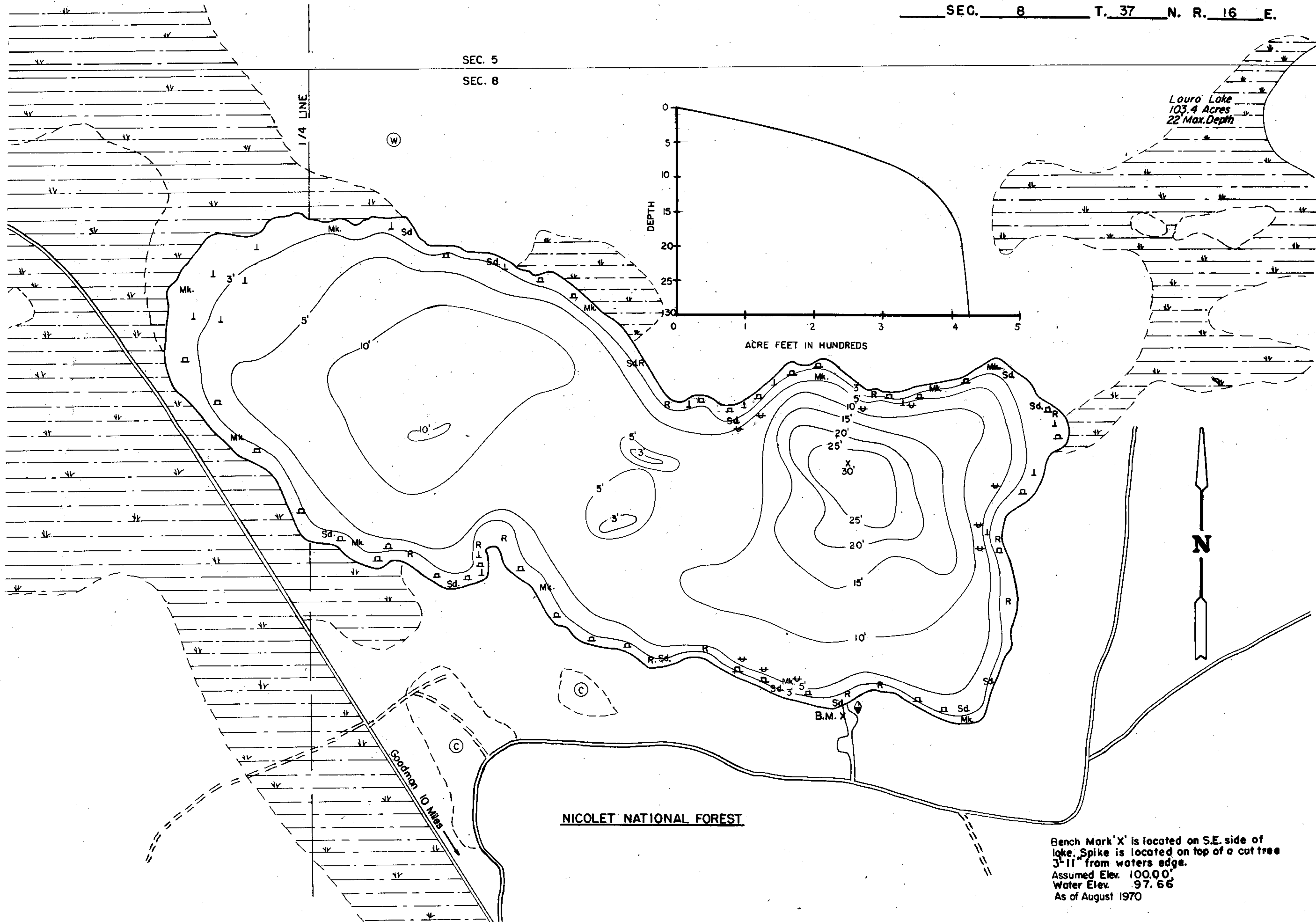

Louro Lake  
103.4 Acres  
22 Max. Depth

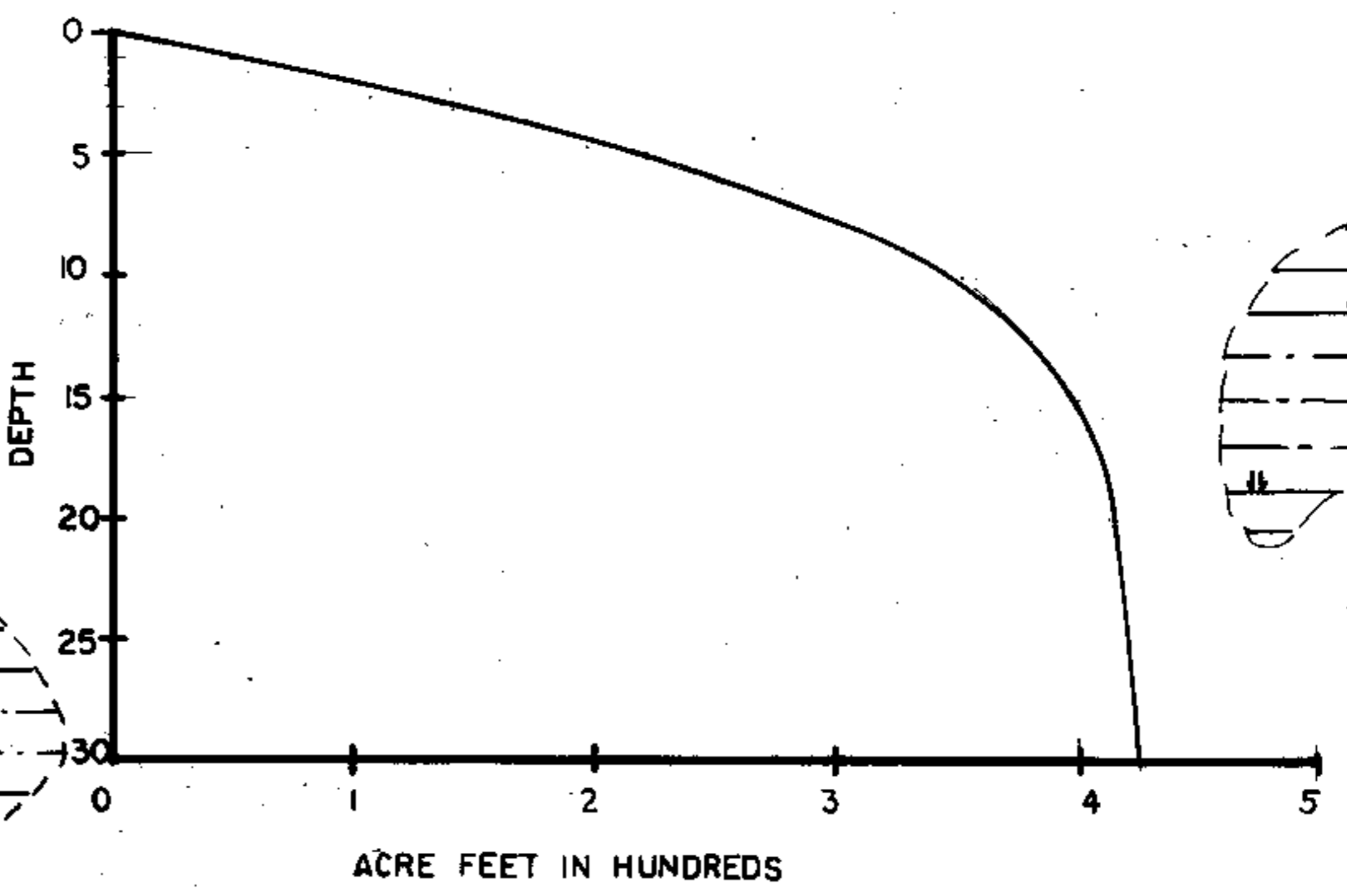

NICOLET NATIONAL FOREST

Bench Mark 'X' is located on S.E. side of lake. Spike is located on top of a cut tree 3'-11" from waters edge.  
Assumed Elev. 100.00'  
Water Elev. 97.66'  
As of August 1970

EQUIPMENT RECORDING SONAR MAPPED AUGUST 1970

- | TOPOGRAPHIC SYMBOLS   |                         | LAKE BOTTOM SYMBOLS |                           |
|-----------------------|-------------------------|---------------------|---------------------------|
| (B) Brush             | Steep slope             | P. Peat             | B Boulders                |
| (PW) Partially wooded | ~ Indefinite shoreline  | Mk. Muck            | o Stumps & Snags          |
| (W) Wooded            | Marsh                   | C. Clay             | Rock danger to navigation |
| (C) Cleared           | Spring                  | M. Marl             | T Submergent vegetation   |
| (P) Pastured          | Intermittent stream     | Sd. Sand            | ↓ Emergent vegetation     |
| (A) Agricultural      | Permanent inlet         | St. Silt            | △ Floating vegetation     |
| B.M. Bench Mark       | Permanent outlet        | Gr. Gravel          | + Brush shelters          |
| ■ Dwelling            | Dam                     | R. Rubble           |                           |
| □ Resort              | D.N.R. State owned land | Bc. Bedrock         |                           |
| ⊠ Camp                |                         |                     |                           |

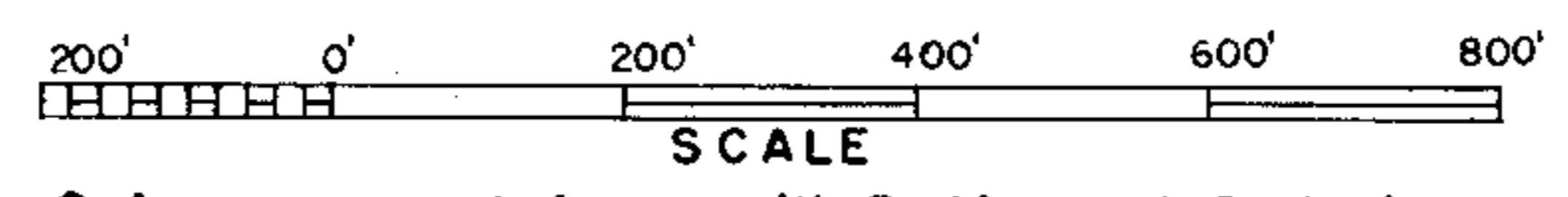

Access Access with Parking Boat Livery

Drawn by: J. Kuehn  
Field work by: R. Crocker & J. Smith

SPECIES OF FISH	Abundance		
	Abundant	Common	Present
Muskie			
N. Pike			
Walleye			
L.M. Bass		X	
S.M. Bass			X
Panfish	X		
Trout			

WATER AREA 50.29 ACRES  
UNDER 3 FT. 13 %  
OVER 20 FT. 4 %  
MAX. DEPTH 30 FEET.  
TOTAL ALK. 1 P.P.M.  
VOLUME 425.99 ACRE FT.  
SHORELINE 1.39 MILES